

PREDATOR TRAPS

Doc series trapping systems



Doc trap setting-tool

Ferrets
Stoats
Rats
Hedgehogs



Department of Conservation
Te Papa Atawhai

The Doc trap setting tool has been developed to assist trap setting. The setting tool fits all Doc traps. Use when trap is screwed/bolted to tunnel floor.

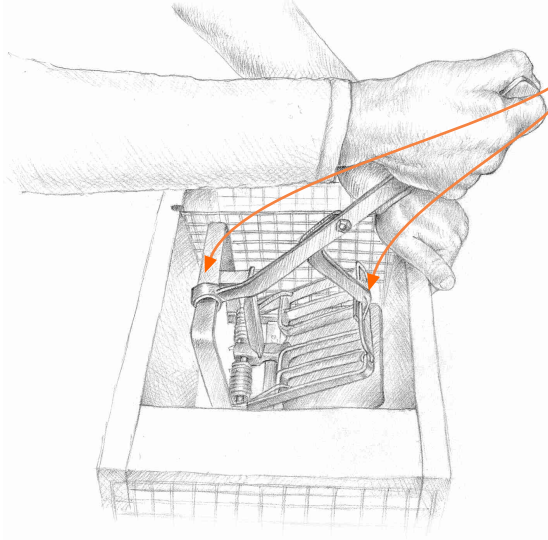

Step one

- | Attach setting-tool to setting handle and back frame.
- | Grasp handle and trap tunnel wall.
- | Firmly pull back on setting-tool to raise kill bar.

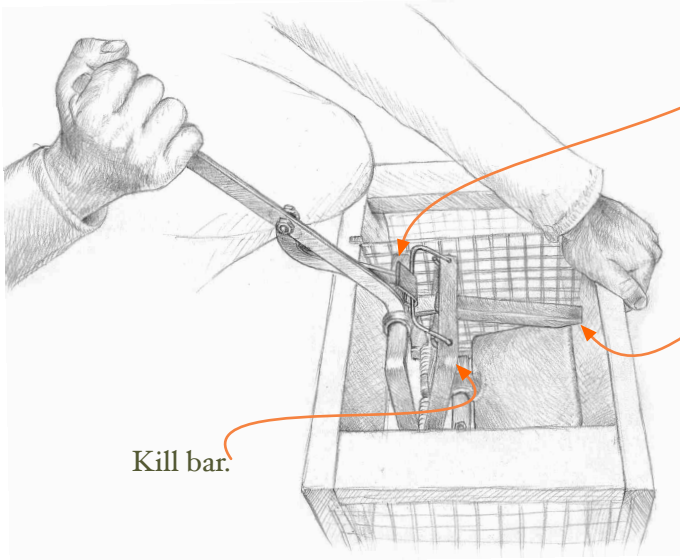

Step two

- | Continue pulling upon setting-tool.
- | Bring kill bar over the top of the trigger arm.

Kill bar.

Trigger arm.

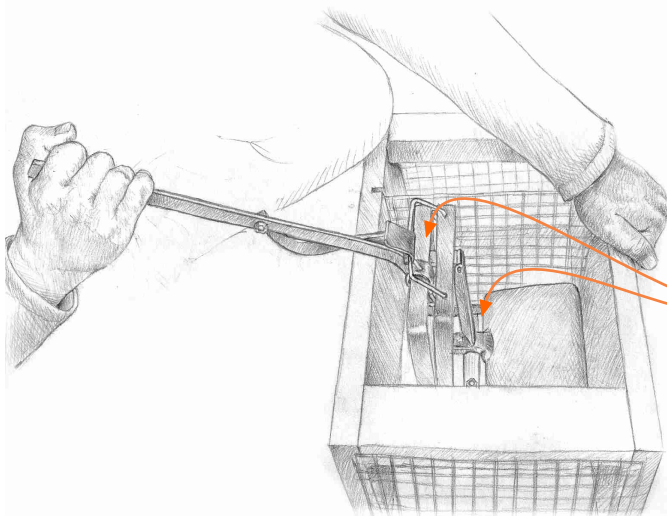

Step three

- | Once kill bar has passed the top of the trigger arm, release setting-tool VERY SLOWLY.
- | Allow the trigger arm to engage the sear.
- | TRAP IS NOW SET.
- | Carefully remove the setting-tool.



Trap setting-tool purchase

Trap setting-tools are available direct from the manufacturers, CMI Springs and Haines Trap Co.



| C M I Springs
Tl 09 579 4089 Fl 09 579 2595
El rossm@cmisprings.co.nz
Al PO Box 3963, Auckland.

| Haines Trap Co. Ltd.
Tl 04 568 6898 Fl 04 5686480
El haines.pallets@paradise.net.nz
Al 111 Hutt Park Road, Seaview.

Advice, contacts and website

Predator control advice, trap development contacts and feedback.



Department of
Conservation
Te Papa Atawhai

| Darren Peters
Department of Conservation
National Predator Control
Research Development & Improvement
Tl 04 471 3256 Fl 04 381 3057
El dpeters@doc.govt.nz
Al P.O. Box 10-420
18-32 Manners Street
Wellington.

The Safety clip

Safety clip application (one clip per order, for use when testing and cleaning trap).

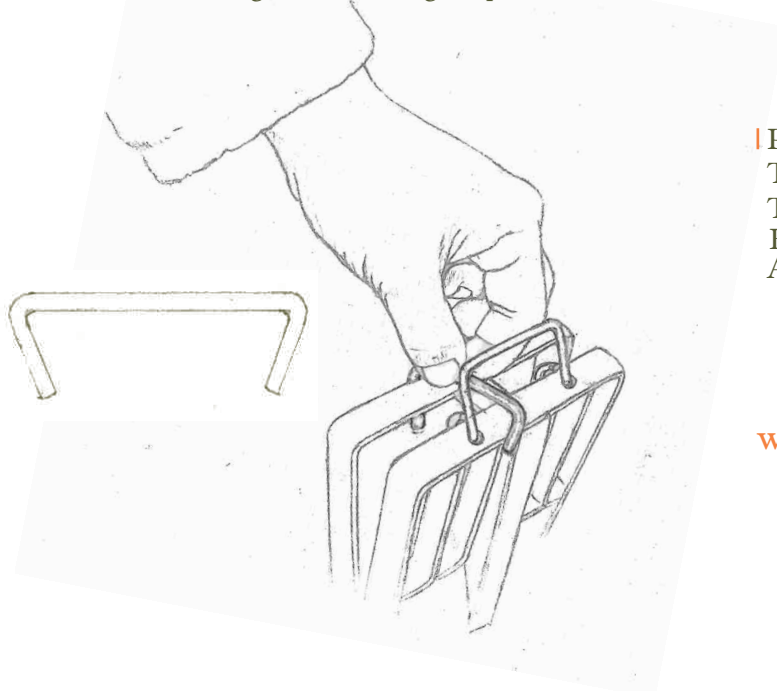

| Phil Waddington
Trap Development
Tl 04 934 5201
El joyphill@paradise.net.nz
Al 5 Collins Street, Petone.

www.predatortraps.com